

ADD CHAMFER (CONE)  
.05 X 45°

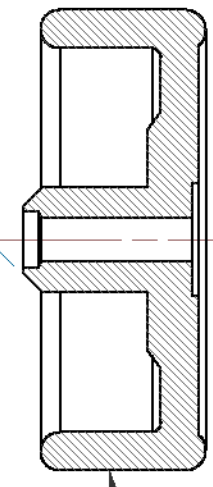

REMOVE MOLD MARKS FROM THIS SURFACE

SECTION A - A  
SCALE 2:1

BoysDad.com IS NOT AN OFFICIAL PUBLICATION OF BOY SCOUTS OF AMERICA. THIS PRODUCT IS NOT ENDORSED OR SPONSORED BY BOY SCOUTS OF AMERICA, Pinewood Derby, and BSA. ARE REGISTERED TRADEMARKS OF BOY SCOUTS OF AMERICA.

SCALE 2:1

(C) Copyright 2009, BoysDad.com

NOTE 1: CHECK YOUR DISTRICT'S RULES REGARDING WHEEL MODIFICATION BEFORE YOU BEGIN.

NOTE 2: USE PIPE CLEANER TO WIPE GRAPHITE ONTO INSIDE OF WHEEL HOLE.

NOTE 3: BUY TWO KIT FOR EACH CAR. USE UNBALANCED WHEELS FOR PRACTICE MACHINING.

ENGINEERED PINEWOOD DERBY PLANS SCOUTING SUPPLIES WWW.BoysDad.com		TITLE BSA Wheel Modifications	
FIRST ISSUED		SIZE/DWG NO.	A wheel_dwgl
DRAWN BY		SCALE	1:1
CHECKED BY		REV.	A
APPROVED BY		SHEET 1 OF 1	

ALL DIMENSIONS IN INCHES  
3D CAD MASTER PART NAME: wheel